

Plotted By:Abibol, Emmanuel Sheet:Mill Creek Pompano Layout C-200 HORIZONTAL CONTROL, SIGNAGE AND MARKING PLAN December 01, 2025 05:34:01pm K:\FTL\_Civil\043 jobs\043175014 Mill Creek Pompano\Design\CADD\Exhibits\2025.08.12 - Easement Exhibit\2025.08.12 - C-Easement.dwg  
This document, together with the concepts and designs presented herein, as an instrument of service, is intended only for the specific purpose and client for which it was prepared. Reuse of and improper reliance on this document without written authorization and adaptation by Kimley-Horn and Associates, Inc. shall be without liability to Kimley-Horn and Associates, Inc.

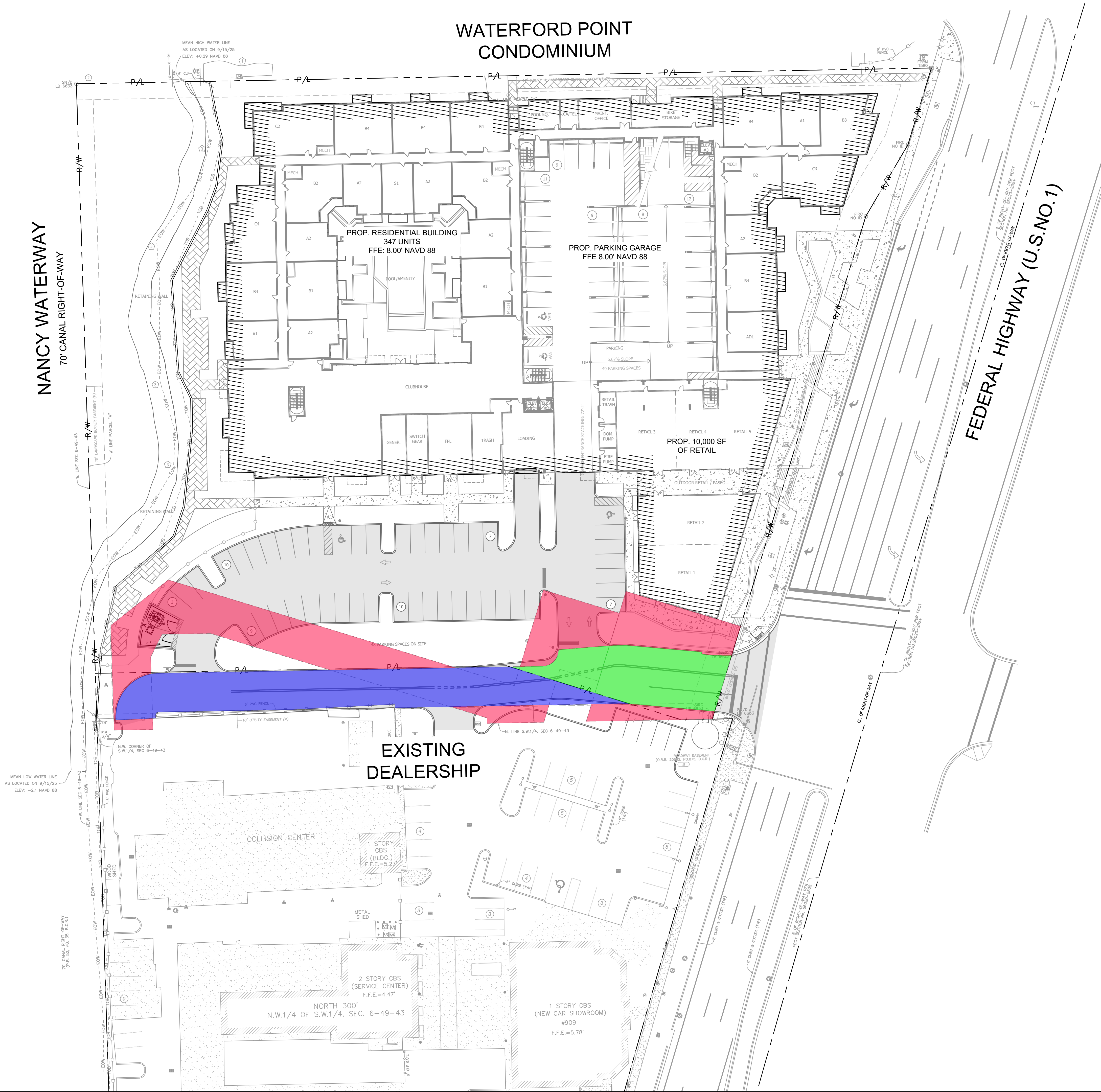

DRC

PZ25-12000028  
01/07/2026

DATE

BY

Kimley»Horn

© 2025 KIMLEY-HORN AND ASSOCIATES, INC.  
8201 PETERS ROAD, SUITE 2200, PLANTATION, FL 33324  
PHONE: 954-555-5100 FAX: 954-739-2247  
WWW.KIMLEY-HORN.COM REGISTRY NO. 35106

KHA PROJECT	043175014
DATE	12/1/2025
SCALE	AS SHOWN
DESIGNED BY	GVF
DRAWN BY	EA
CHECKED BY	GVF

MODERA POMPANO BEACH  
PREPARED FOR  
MCRT INVESTMENTS LLC  
POMPANO BEACH FLORIDA

SHARED ACCESS  
EASEMENT EXHIBIT

SHEET NUMBER  
EX-1